

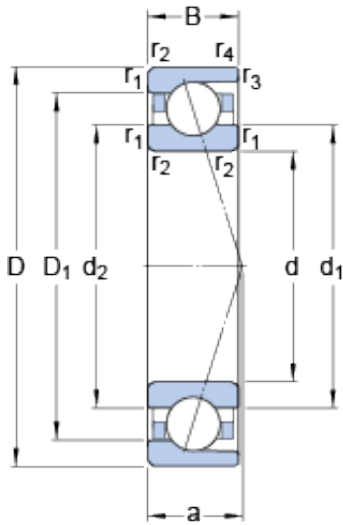

## Bearing import and Export Co., Ltd



7228 ACD/P4A Bearing 2D drawings and 3D CAD models

### 140 mm x 250 mm x 42 mm SKF 7228 ACD/P4A angular contact ball bearings

Bearing No. 7228 ACD/P4A

Size	250x140x42 mm
Bore Diameter	250 mm
Outer Diameter	140 mm
Width	42 mm
d	140 mm
D	250 mm
B	42 mm
d <sub>1</sub>	176.8 mm
d <sub>2</sub>	176.8 mm
D <sub>1</sub>	213.2 mm
r <sub>1,2</sub> - min.	3 mm
r <sub>3,4</sub> - min.	1.5 mm
a	66.7 mm
d <sub>a</sub> - min.	154 mm
d <sub>b</sub> - min.	154 mm
D <sub>a</sub> - max.	236 mm
D <sub>b</sub> - max.	241 mm
r <sub>a</sub> - max.	2.5 mm
r <sub>b</sub> - max.	1.5 mm
d <sub>n</sub>	184.8 mm
Basic dynamic load rating - C	212 kN
Basic static load rating - C <sub>0</sub>	228 kN
Fatigue load limit - P <sub>u</sub>	7 kN
Limiting speed for grease	5000 r/min



## Bearing import and Export Co., Ltd

Lubrication	
Limiting speed for oil lubrication	7500 mm/min
Ball - $D_w$	30.162 mm
Ball - $z$	18
$G_{ref}$	83.931 cm <sup>3</sup>
Calculation factor - $e$	0.68
Calculation factor - $Y_2$	0.87
Calculation factor - $Y_0$	0.38
Calculation factor - $X_2$	0.41
Calculation factor - $Y_1$	0.92
Calculation factor - $Y_2$	1.41
Calculation factor - $Y_0$	0.76
Calculation factor - $X_2$	0.67
Preload class A - $G_A$	1350 N
Preload class B - $G_B$	2700 N
Preload class C - $G_C$	5400 N
Preload class D - $G_D$	10800 N
Calculation factor - $f$	1.09
Calculation factor - $f_1$	0.99
Calculation factor - $f_{2A}$	1
Calculation factor - $f_{2B}$	1.01
Calculation factor - $f_{2C}$	1.02
Calculation factor - $f_{2D}$	1.05
Calculation factor - $f_{HC}$	1
Preload class A	397 N/micron
Preload class B	516 N/micron
Preload class C	679 N/micron
Preload class D	911 N/micron



## Bearing import and Export Co., Ltd

$d_1$	176.8 mm
$d_2$	176.8 mm
$D_1$	213.2 mm
$r_{1,2}$ min.	3 mm
$r_{3,4}$ min.	1.5 mm
$d_a$ min.	154 mm
$d_b$ min.	154 mm
$D_a$ max.	236 mm
$D_b$ max.	241 mm
$r_a$ max.	2.5 mm
$r_b$ max.	1.5 mm
$d_n$	184.8 mm
Basic dynamic load rating C	212 kN
Basic static load rating $C_0$	228 kN
Fatigue load limit $P_u$	6.95 kN
Attainable speed for grease lubrication	5000 r/min
Attainable speed for oil-air lubrication	7500 r/min
Ball diameter $D_w$	30.162 mm
Number of balls z	18
Reference grease quantity $G_{ref}$	83.931 cm <sup>3</sup>
Preload class A $G_A$	1350 N
Static axial stiffness, preload class A	397 N/ $\mu$ m
Preload class B $G_B$	2700 N
Static axial stiffness, preload class B	516 N/ $\mu$ m
Preload class C $G_C$	5400 N
Static axial stiffness, preload class C	679 N/ $\mu$ m
Preload class D $G_D$	10800 N
Static axial stiffness, preload class D	911 N/ $\mu$ m



## Bearing import and Export Co., Ltd

class D	
Calculation factor f	1.09
Calculation factor $f_1$	0.99
Calculation factor $f_{2A}$	1
Calculation factor $f_{2B}$	1.01
Calculation factor $f_{2C}$	1.02
Calculation factor $f_{2D}$	1.05
Calculation factor $f_{HC}$	1
Calculation factor e	0.68
Calculation factor (single, tandem) $Y_2$	0.87
Calculation factor (single, tandem) $Y_0$	0.38
Calculation factor (single, tandem) $X_2$	0.41
Calculation factor (back-to-back, face-to-face) $Y_1$	0.92
Calculation factor (back-to-back, face-to-face) $Y_2$	1.41
Calculation factor (back-to-back, face-to-face) $Y_0$	0.76
Calculation factor (back-to-back, face-to-face) $X_2$	0.67
Mass bearing	8.14 kg